

armatile
innovation in tile design



**“We Create Unique Tile
Designs for Architects,
Designers, Specifiers
and...”**

**Armatile
Station Road Industrial Estate
Loughgall Road
Armagh
Northern Ireland
BT61 7NP
028 3752 7007**

armatile.com

armatilearchitectural.com



- 2004** Best Use of a Tile by an Architect or Designer
- **St Patrick's Cathedral, Armagh**
- 2006** Best Technical Use of a Tile in a Construction Contract
- **Ennis Information Age Park, Ennis**
- 2008** Best Use of a Tile in a Small Construction Contract
- **Holy Family Church, Belfast**
- 2009** Best Use of a Tile by an Architect or Designer
- **Peter Mark's Style Club, Dublin**
- 2010** Best Use of a Tile by an Architect or Designer
- **St Patrick's Church, Dungannon**
- 2010** Best Use of a Tile in a Small Construction Contract
- **St Patrick's Church, Dungannon**
- 2012** Best Technical Use of a Tile in a Contract
- **St Peters Church, Lurgan**



The Process

- 1. The Initial Consultation**
Discuss Ideas & Concepts
- 2. The Free Design Stage**
Armatile provides free colour drawings of product ideas for approval
Agree Design & Proceed to:
- 3. Project Pricing Stage**
Agree Budgets & Proceed to:
- 4. The Sample Stage**
Armatile can provide a physical sample for approval
Agree Sample & Proceed to:
- 5. The Final Designs Presented**
Agree Final Drawings, Sample and Budgets
Proceed to:
- 6. Production**



1. The Initial Consultation

The Client presents their plans and discusses a brief with Armatile's Representatives incorporating:

- design requirements
- concepts
- colours
- potential materials & textures
- timescales
- budget

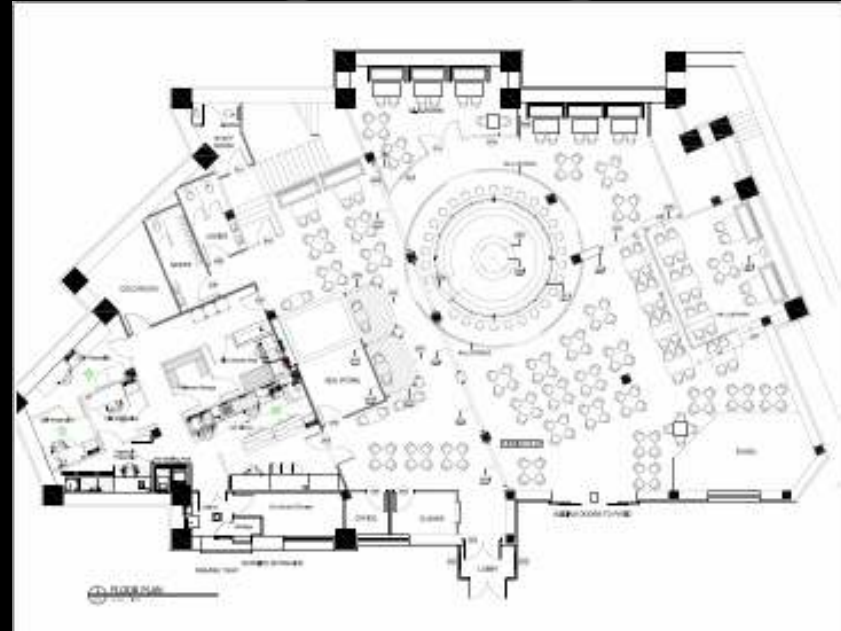



2. The Free Design Stage

Armatile's Design Team develop the brief and produce initial drawings to present to the client for discussions and approvals. This **Free Design Service** helps develop the ideas for the Client into practical designs.

The Client will either approve the initial drawings and proceed to the **Project Pricing Stage** or Armatile's Design Team will re-design and alter the drawings.

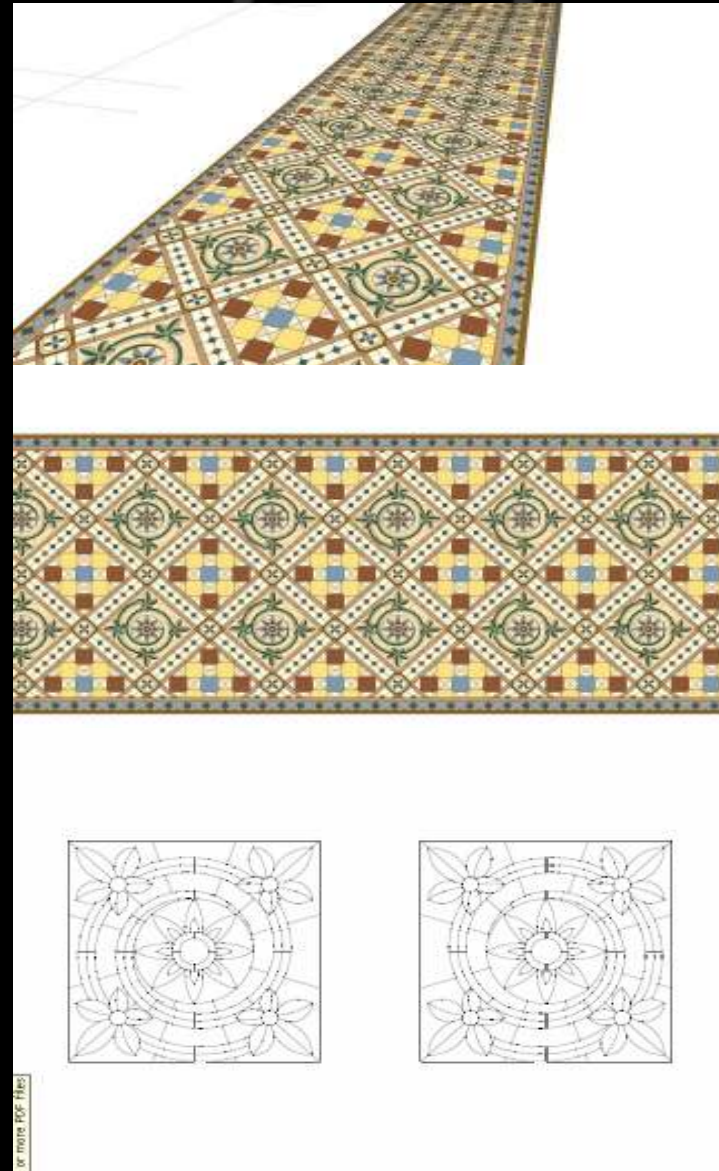

or more PDF files



4. **The Sample Stage**

An important part of the Armatile Design and Manufacture service is the **Physical Sample**.

Having agreed the initial drawings Armatile can produce a sample for the client to approve before full production proceeds.

The client will either approve the sample or another sample can be produced to satisfy any further specific requirements.





5. The Final Designs

As a final measure to ensure Client satisfaction Armatile's Design Team will incorporate all the design features into the existing architectural drawings.

The final drawing is presented to the Client to ensure all aspects of the brief have been fulfilled prior to full production.

The Client will approve the final drawings, authorise the order and proceed to the Production Stage or will ask for a changes to be made before authorising.

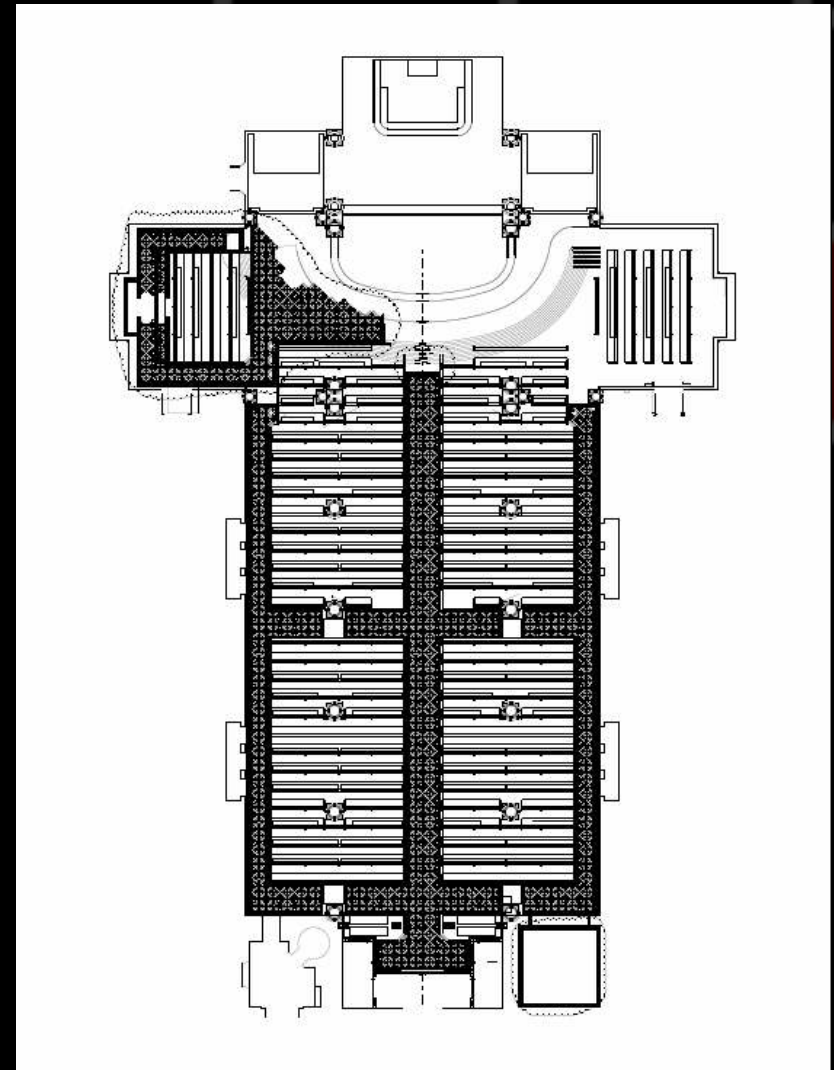



6. Production

With Final Designs approved in **Stage 5** Armatile's experienced Production, Manufacturing and Quality Control Teams will work closely to create the Client's customised design and bring reality to their dream concept.

This dream is achieved to the highest standards in our custom built factory in Armagh, Northern Ireland.



armatile
innovation in tile design



Armatile Ltd,
Station Road Industrial Estate,
Loughgall Road,
Armagh,
Northern Ireland
BT61 7NP

T:028 3752 7007

F:028 3752 6944

enquiry@armatile.com

contracts@armatile.com

armatile.com

armatilearchitectural.com

armatile.com

armatilearchitectural.com